

# Set up Cross Signing

## On first login to a new account

1. Sign up or log in
2. Click [Generate a Security Key](#) or [Enter a Security Phrase](#). Then click [Continue](#)
3. Take note of your key, then click [Continue](#)

## If you did not set it up on first login, or if you did not get asked

1. If you do not have key backup configured, you will be asked to set it up the first time you enter an encrypted room. Click [Start using Key Backup](#)

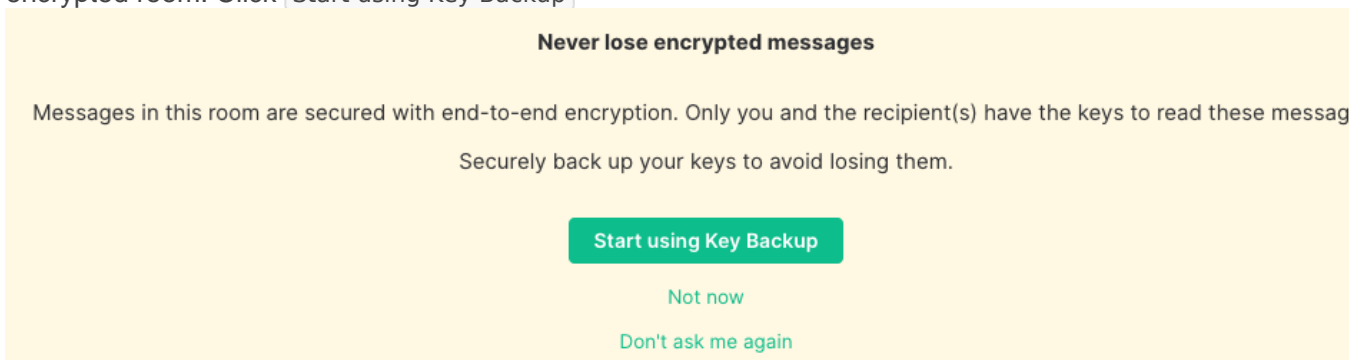

2. Click [Generate a Security Key](#) or [Enter a Security Phrase](#). Then [Continue](#)
3. Take note of your key, then click [Continue](#)
4. Enter your account password, then click [Continue](#)

## If you clicked Don't ask me again

1. Go to Element [Security & Privacy](#) settings

2. Click

## Encryption

### Key backup

Your keys are **not being backed up from this session**.

Encrypted messages are secured with end-to-end encryption. Only you and the recipient(s) have the keys to read these messages.

Back up your keys before signing out to avoid losing them.

3. Click  or . Then
4. Take note of your key, then click
5. Enter your account password, then click

---

Revision #3

Created 18 April 2022 14:20:12 by Karl Abbott

Updated 6 November 2024 12:29:02 by Kieran Mitchell Lane